

ATTENTION

1. ClearTV™ Digital HDTV Antenna is intended for indoor use only.
2. The location of the antenna is important to maximize signal strength. The antenna should be kept far from any disturbance source, big electrical appliances like air conditioners, elevator, washing machine, blower or microwave oven, etc.
3. Window mounting results in the best performance. The incoming signals will not be downgraded by objects in the home, office or vehicle. Please ensure the antenna is not blocked by aluminum or metallic screening as this will degrade incoming signals.
4. Be sure to hang the antenna vertically with the cable on the bottom.
5. Maintenance of antenna: please use soft cloth with diluted mild detergent to clean its shell.

Manufacturer's Limited Warranty

The manufacturer warrants that your ClearTV™ is free of defects in materials and workmanship and will, at its option, repair or replace any defective ClearTV™ that is returned to it. This warranty runs for sixty (60) days from the original date of purchase, and is valid only in accordance with the conditions set forth below:

1. Normal wear and tear are not covered by this warranty. This warranty applies to consumer use only, and is void when the product is used in a commercial or institutional setting.
2. The warranty extends only to the original consumer purchaser and is not transferable. In addition, proof of purchase must be demonstrated. This warranty is void if the product has been subject to accident, misuse, abuse, improper maintenance or repair, or unauthorized modification.
3. This limited warranty is the only written or express warranty given by the manufacturer. Any implied warranty of merchantability or fitness for a particular purpose on this product is limited in duration to the duration of this warranty. Some states do not allow limitations on how long an implied warranty lasts, so the above limitation may not apply to you.
4. Repair or replacement of the product (or, if repair or replacement is not feasible, a refund of the purchase price) is the exclusive remedy of the consumer under this warranty. The manufacturer shall not be liable for any incidental or consequential damages for breach of this warranty or any implied warranty on this product. Some states do not allow the exclusion or limitation of incidental or consequential damages, so the above limitation or exclusion may not apply to you.
5. This warranty gives you specific legal rights, and you may also have other rights which vary from state to state.

Procedure for Warranty Repairs or Replacement:

If warranty service is necessary, the original purchaser must pack the product securely and send it postage paid with a description of the defect, proof of purchase, and a check or money order for \$7.95 to cover return postage and handling to the following address:
ClearTV™, P.O. Box 3007, Wallingford, CT 06492.



**The Super Thin Flat Digital Indoor Antenna
specially designed for digital TV!**

FEATURES

- Innovative flat, razor-thin antenna design.
- Receives digital and HDTV channels.
- Multi-directional design pulls in signals from all directions.
- Easy installation, no assembly required.
- Suction fasteners make for easy setup and placement.



Stand Not Included
Order accessories at buycleartv.com

SETTING UP YOUR CLEAR TV

Read Installation Instructions Before Permanently Mounting Antenna

Step 1 — CONNECTING ANTENNA TO A TV WITH A DIGITAL TUNER

Attach the mini coax cable, which is the small black cable coming from the antenna. Simply screw the connector into the ANTENNA IN or CABLE IN port on the back of your television.

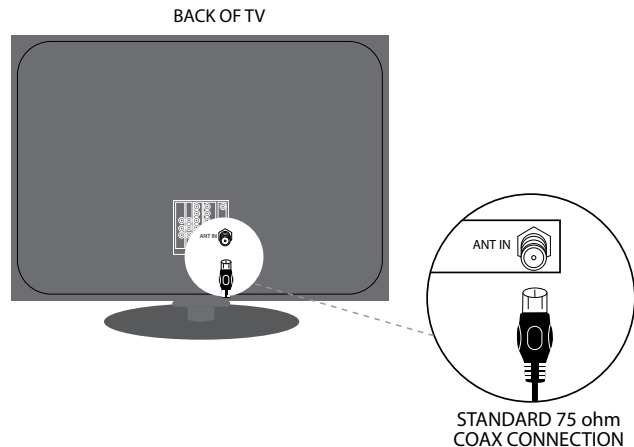

IMPORTANT!

TV must be a digital TV to receive a digital HD broadcast.

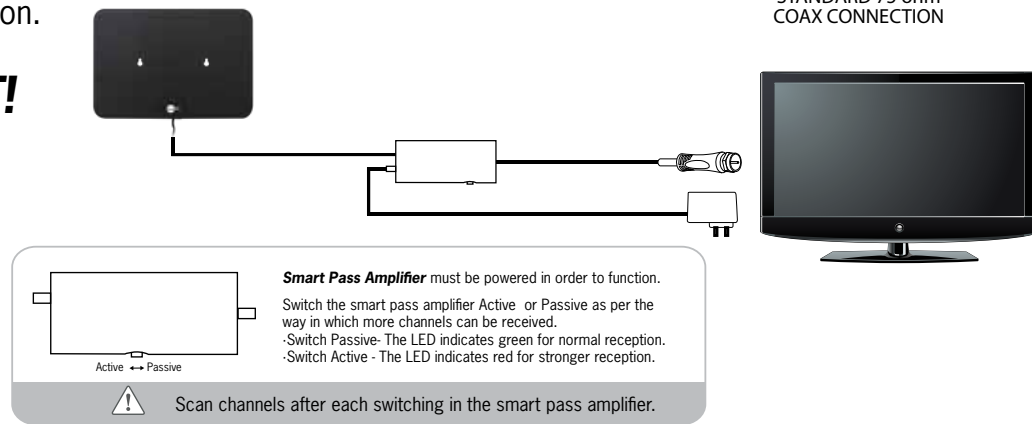

CONNECTING ANTENNA TO A TV WITHOUT A DIGITAL TUNER

Attach the mini coax cable, which is the small black cable coming from the antenna. Simply screw the connector into the ANTENNA IN or CABLE IN port on the back of your set-top converter box, and then connect you set-top converter box to the back of your television.

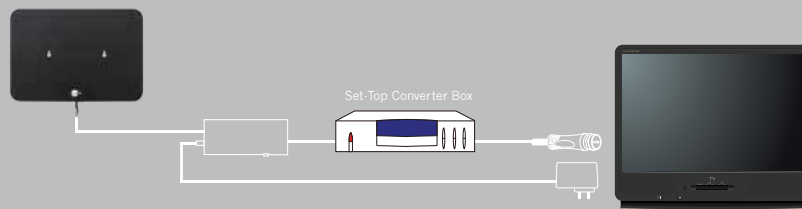

Wall Mounting

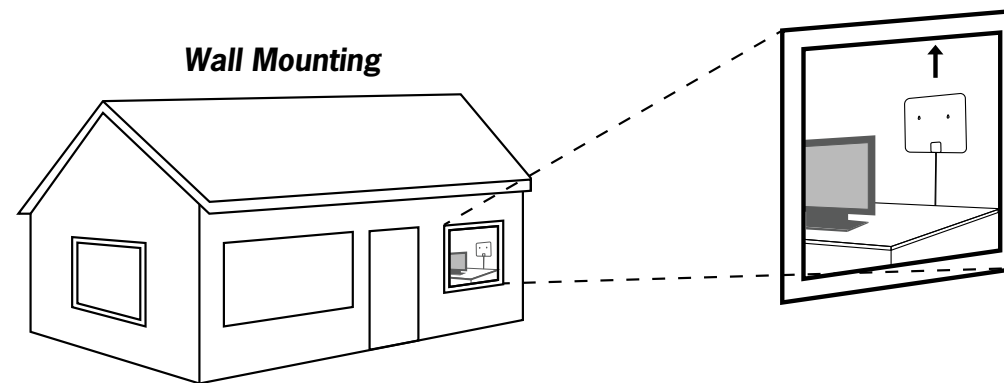

Step 2A — MOUNTING ANTENNA TO WALL

For mounting your antenna on a wall, simply remove the suction cups and use the holes to mount your antenna in your desired location. We recommend using tape to temporarily stick the antenna to the wall before permanently mounting it with the screws provided.





Window Mounting

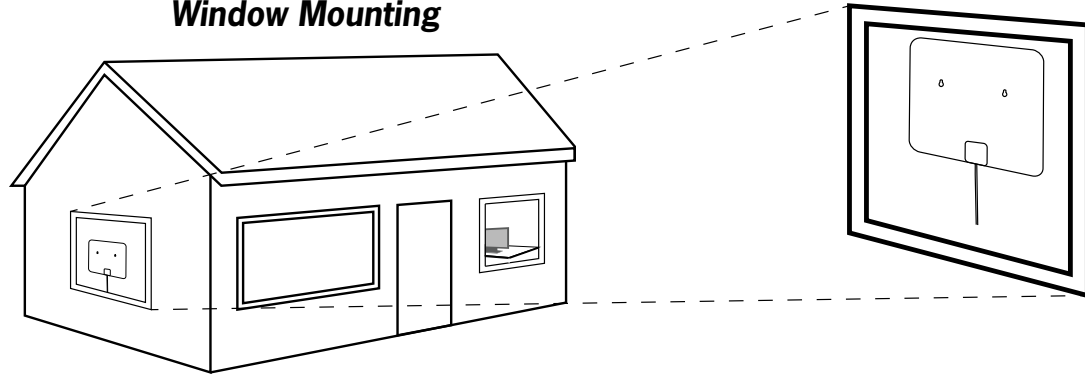

Step 2B — MOUNTING ANTENNA TO WINDOW

Firmly push the suction cups into place along the top of the windowpane. (Use caution when applying pressure to glass window.)

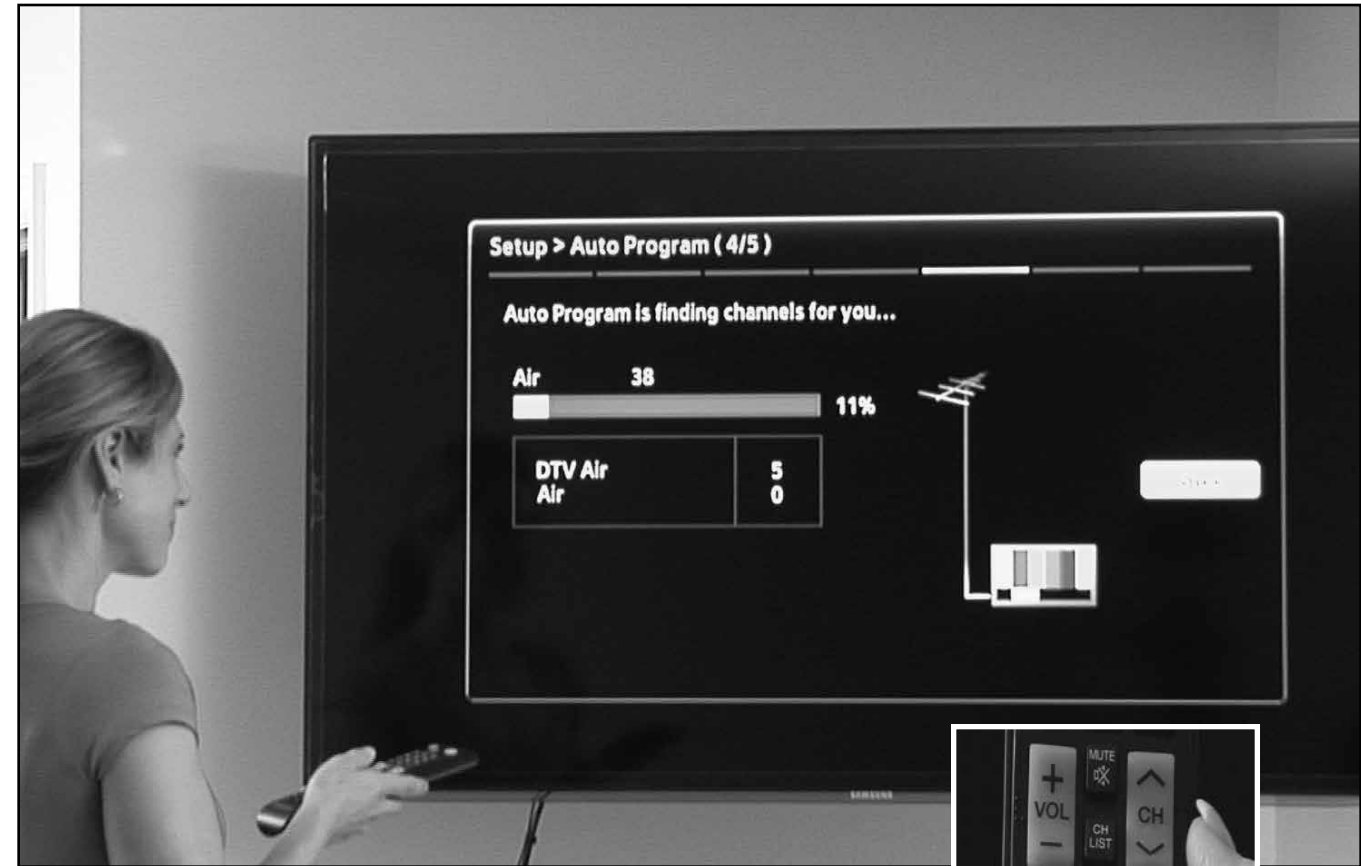

Step 3 — AUTO PROGRAM SCAN

Using your TV's remote control, navigate to the system menu and set the TV's input to ANTENNA. Then begin an auto search or auto program to find new stations.

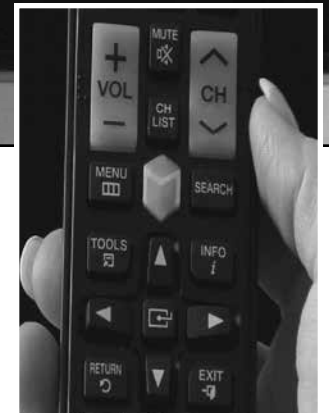

Step 4 — ADJUSTING ANTENNA LOCATION

To maximize the number of stations, you may need to adjust or reposition the antenna. Try placement in alternate locations and re-scan for new channels. We recommend Clear TV be used within 35 miles of the broadcasting towers.

Frequently Asked Questions

What is Clear TV?

A government mandate requires television broadcasters to convert from analog to digital broadcast. Now, only digital signals are available over the air in the United States and Canada. Clear TV is an antenna that receives over-the-air digital and HD signals for free. The signal is a better visual and audio quality than analog. Digital television enables broadcasters to offer multiple programming choices on a single channel (sub channels), greatly expanding viewer choices.

How many channels can I receive over the air?

Reception will vary based on factors like geography and location of the broadcast signal; antenna, hills, buildings and even tall trees can impact reception. It is recommended that you be within 35 miles of a broadcast antenna. Most households can receive these popular networks: PBS, NBC, CBS, ABC, FOX, ION, CW, Qubo - a children's channel, 24-hour sports programming, a 24-hour classic movie channel, 24-hour news and weather, and popular Spanish-language channels: Azteca, Univision, Telemundo, TeleFutura, may also be available.

Will I receive Cable shows?

No, Clear TV does not receive shows that are produced for cable only.

Will it fit all Televisions?

Clear TV will connect with televisions that have an Antenna IN or a Cable IN port on the back of the television. Most televisions sold after May 25, 2007 are required by law to have an ATSC (Digital) tuner built-in and will receive digital broadcasts. If your television was purchased earlier, but has a menu option for scanning digital channels, then your television has a digital ATSC tuner. Check for the letters 'ATSC'. If it does not say that it is equipped with an ATSC tuner, you will need to purchase a converter box.

Can I use it outside, in my attic, or basement?

Clear TV is designed as an indoor antenna only. We recommend Clear TV be hung on the inside of an exterior wall or window that is facing the broadcast towers. Placing it in a basement or attic is not recommended. Exposure to outside elements such as moisture or temperature extremes can be harmful to your antenna.

Can I add an extension cable to my Clear TV?

Yes, if you would like to move your Clear TV to a location that exceeds the reach of the cable connected to your antenna you can purchase an extension cable.

Are all broadcasts now in High Definition?

Not all digital signals are High Definition.

Is the picture better than cable?

All cable companies compress their HD signals; the result is a degraded signal that is usually inferior to Over the Air (OTA) broadcast.

What is signal compression?

Signal compression is a method of making video transmissions smaller. The quality of the signal is degraded in order to fit in more quantity. All cable companies compress their signals in order to make room for all of those extra channels. OTA broadcast television signals are not compressed and are therefore better quality.

Does Clear TV work with my DVR or TIVO?

Yes, Clear TV is compatible with TiVo and other digital video recorders (DVR) so you can watch what you want, when you want. Since Clear TV is a HD antenna and can receive a HD broadcast signal there is no need for an HD converter box.

Will the channel numbers be the same?

With the digital system, the channel number that appears on your television screen and the actual channel number can be and often are different. Many stations have sub channels (channel 2, channel 2.1, 2.2, 2.3, etc.). Keep in mind reception will vary in your area due to geography and location of the broadcast antenna.

What if I can't receive a signal with Clear TV?

Signal strength will vary based on certain variables, such as distance from the transmitter, hills, buildings, and even tall trees can impact reception. To check the exact distance from your residence to the nearest transmitters, and get an idea of what to expect in the way of reception, go to antennaweb.org and type in your address. It is recommended that you be within 35 miles of a broadcast antenna.

Clear TV Reception Tips

Place Clear TV in the location with the strongest reception, typically this will be on an exterior wall or window. A television signal can become weak or intermittent by passing through walls that are exceptionally thick or contain large amounts of metal. In this case, consider attaching Clear TV to the inside surface of a window pane using the provided suction cups. This will help to capture a weak station. However, Clear TV or the cable should never be allowed to interfere with the normal operation of the window.

For optimal performance

Place Clear TV on the inside surface of an exterior wall, ideally a wall facing the general direction of local transmission towers. (You can find out the location of your towers by going to antennaweb.org.) If there are multiple tower locations, optimize the position of Clear TV to the weakest signal. Clear TV can pick up the stronger signals from any direction. Experiment with different walls and even different rooms to find the best location.

Concealing Clear TV behind your Television or Artwork

Hiding Clear TV behind your television, artwork, wall hangings, or even furniture should not affect its performance. We recommend that you find the best location for your antenna, which may or may not be behind these items.